

MEWP Familiarization: 69 Series

- 3369ERT
- 3369RT
- 4069ERT
- 4069RT

69 Series Familiarization

(ANSI A92.22 6.2.5)

- 6.2.5.1 Prior to user's authorization of an operator to use a specific model of MEWP, the user must ensure the operator is familiarized on the following, and as specified by the manufacturer.
- Do not operate your MEWP until you have read and understood the Manufacturer's Operator Manual, have performed the workplace risk inspection, pre-start inspection, routine maintenance, and have completed all the test operations detailed in the operating instructions section of your manual.
- **Manual location is in manual enclosure on the inside of the front guardrail.**
- **Confirm that the required manual(s) as specified by the manufacturer are with the MEC 69 Series.**

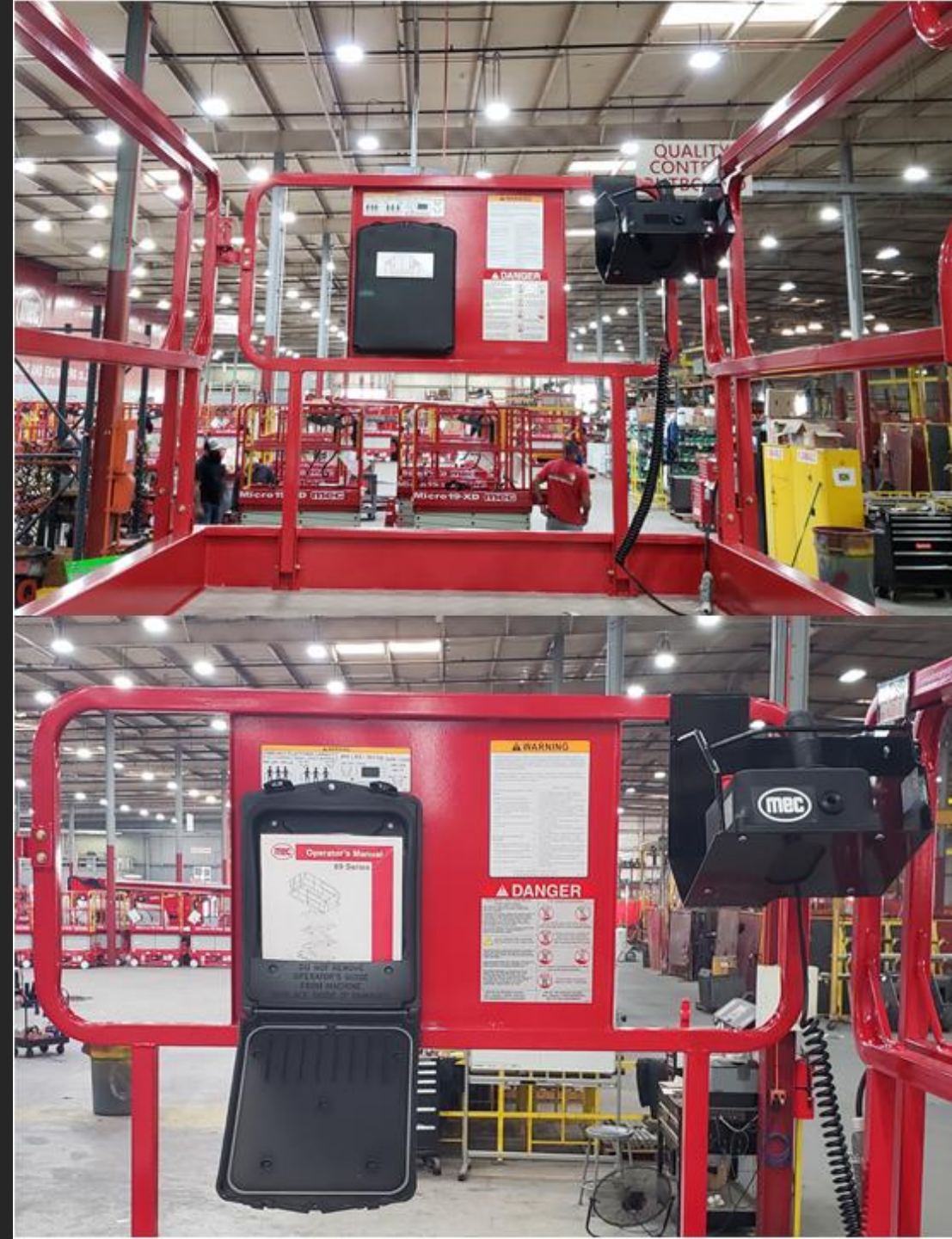

RT Lower Controls

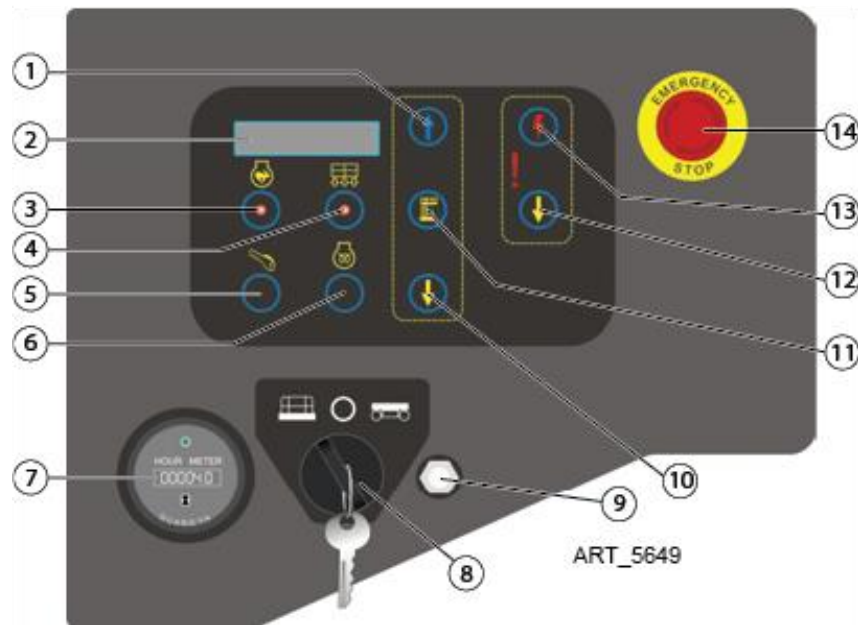

Control	Description
1	Platform Up Button Press this button and the platform will lift.
2	Display Diagnostic readout.
3	Engine Idle Select Button Press this button to select the engine idle setting. Light on indicates high idle is selected. Light off indicates low idle is selected.
4	Overload Indicator Light Light on indicates when platform is overloaded (if fitted).
5	Engine Start Button Press this button to start the engine.
6	Engine Glow Plug Button Press and hold this button to preheat engine.
7	Hour Meter The hour meter displays the number of hours the machine has operated.
8	Key Switch Turn the key switch to the platform position and the platform controls will operate. Turn the key switch to the off position and the machine will be off. Turn the key switch to the base position and the ground controls will operate.
9	Circuit Breaker Circuit breaker
10	Platform Down Button Press the button and the platform will lower.
11	Lift Function Enable Button Press and hold this button along with the Platform Up Button or the Platform Down Button.
12	Emergency Lowering Down Button Press this button and the platform will lower.
13	Emergency Lowering Down Enable Button Press this button to activate the Emergency down function.
14	Red Emergency Stop Button Push in the red Emergency Stop button to the off position to stop all functions. Turn the red Emergency Stop button clockwise to the on position to operate the machine.

RT Upper Controls

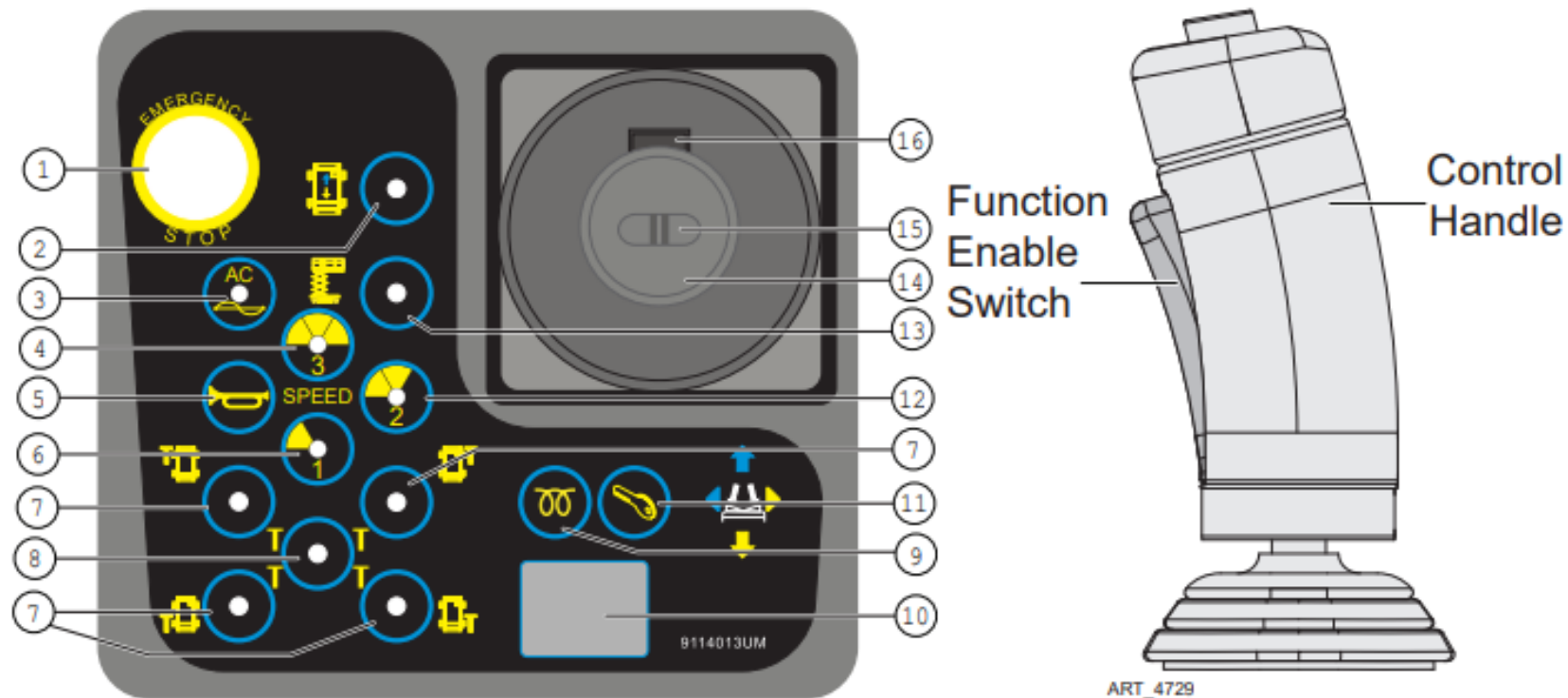

Control	Description
1 Red Emergency Stop Button	Push in the red Emergency Stop button to the off position to stop all functions. Pull out the red Emergency Stop button to the on position to operate the machine.
2 Drive Function Select Button	Press this button to activate the drive function. The indicator light will turn on.
3 Generator Select Button (if Equipped)	Press this button to turn the generator on. Indicator light will be on. Press the button again to turn the generator off.
4 Speed 3	Fastest speed suitable only when on a smooth flat improved surfaces when conditions are safe.
5 Horn Button	Press this button and the horn will sound. Release the button and the horn will stop.

RT Upper Controls

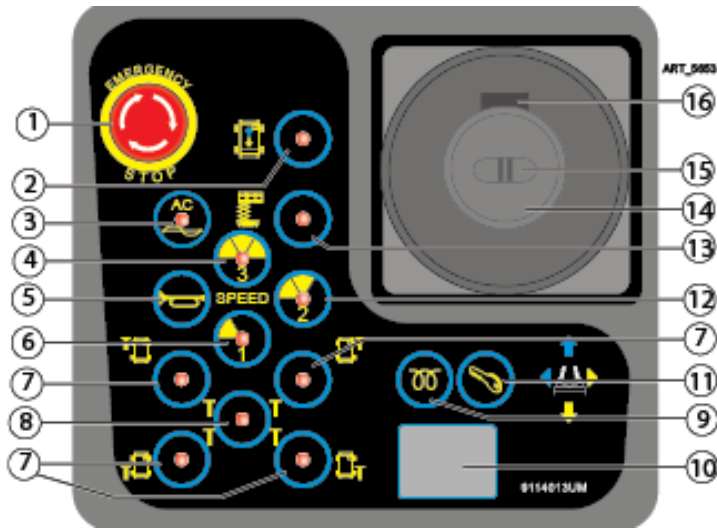

Control	Description
6 Speed 1	High torque drive which initiates traction control valves and should be used when driving on any slopes greater than 10% or over a rough surface.
7 Outrigger Function Button	Press and hold button then operate the represented individual outrigger up/down function.
8 Outrigger Auto Level Button	Press and hold button then operate the auto level function.
9 Engine Glow Plug Button	Press and hold this button to preheat engine.
10 LED Readout Screen	Diagnostic readout.
11 Engine Start Button	Press this button to start the engine.
12 Speed 2	Medium speed suited for driving on flat but unimproved surfaces.
13 Lift Function Select Button	Press this button to activate the lift function. The indicator light will turn on.
<p>You must first select either Lift, Drive or Outrigger to activate selection function:</p> <p>Lift Function: Press and hold the function enable switch to enable the lift function on the platform control handle. Pull the control handle in the direction of upwards and the platform will raise. Move the control handle in the direction of downwards and the platform will lower. The descent alarm should sound while the platform is lowering.</p> <p>Drive Function: Press and hold the function enable switch to enable the drive function on the platform control handle. Move the control handle in the direction indicated by the blue arrow on the control panel and the machine will move in the direction that the blue arrow points. Move the control handle in the direction indicated by the yellow arrow on the control panel and the machine will move in the direction that yellow arrow points.</p> <p>Outrigger extendable/retractable function: Press and hold the function enable switch to enable the Outrigger extend/retract function on the platform control handle. Move the control handle in the direction indicated by the yellow arrow and the outrigger will extend. Move the control handle in the direction indicated by the blue arrow and the outrigger will retract.</p>	
15 Thumb Rocker Switch	Pres the thumb rocker switch in a direction to activate steer function according to the blue and yellow steer arrows.
16 Function Enable Switch	Press and hold the function enable switch to enable the drive/lift function.

ERT Lower Controls

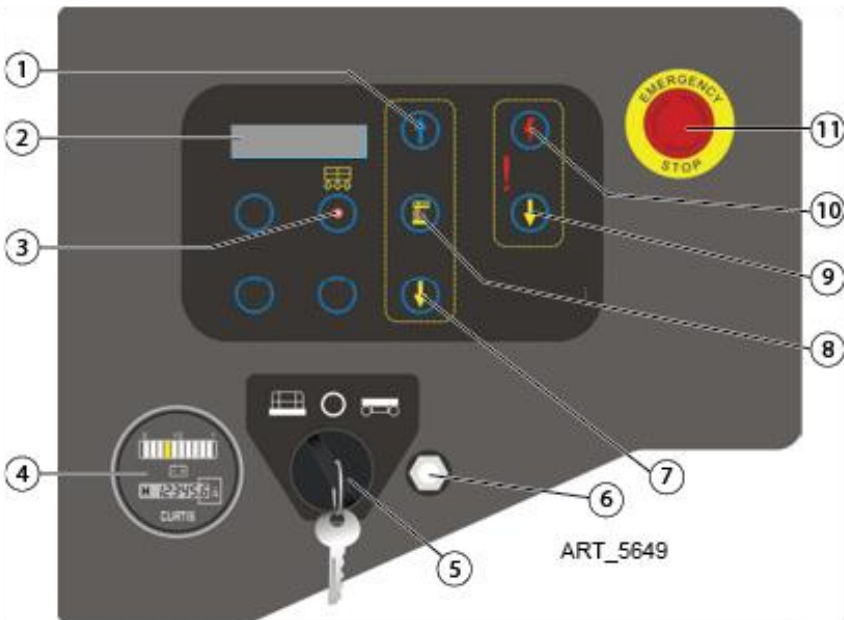

Control	Description
1 Platform Up Button	Press the Lift Function Enable Button (#8) and this button then the platform will lift.
2 Display	Diagnostic readout.
3 Overload Indicator Light	Light on indicates when platform is overloaded (If fitted).
4 Battery Gauge & Hour Meter	The battery gauge & hour meter displays the number of hours the machine has operated and the battery level.
5 Key Switch	Turn the key switch to the platform position and the platform controls will operate. Turn the key switch to the off position and the machine will be off. Turn the key switch to the base position and the ground controls will operate.
6 Circuit Breaker	Trips when there is excessive electrical load. Push to reset.
7 Platform Down Button	Press the Lift Function Enable Button (#8) and this button then platform will lower.
8 Lift Function Enable Button	Press and hold this button along with the Platform Up Button or the Platform Down Button.
9 Emergency Lowering Down Button	Press the Emergency Lowering Down Enable Button (#10) and this button then the platform will lower.
10 Emergency Lowering Down Enable Button	Press this button and the Emergency Lowering Down Button (#19) to activate the Emergency down function.
11 Red Emergency Stop Button	Push in the red Emergency Stop button to the off position to stop all functions. Turn the red Emergency Stop button clockwise to the on position to operate the machine.

ERT Upper Controls

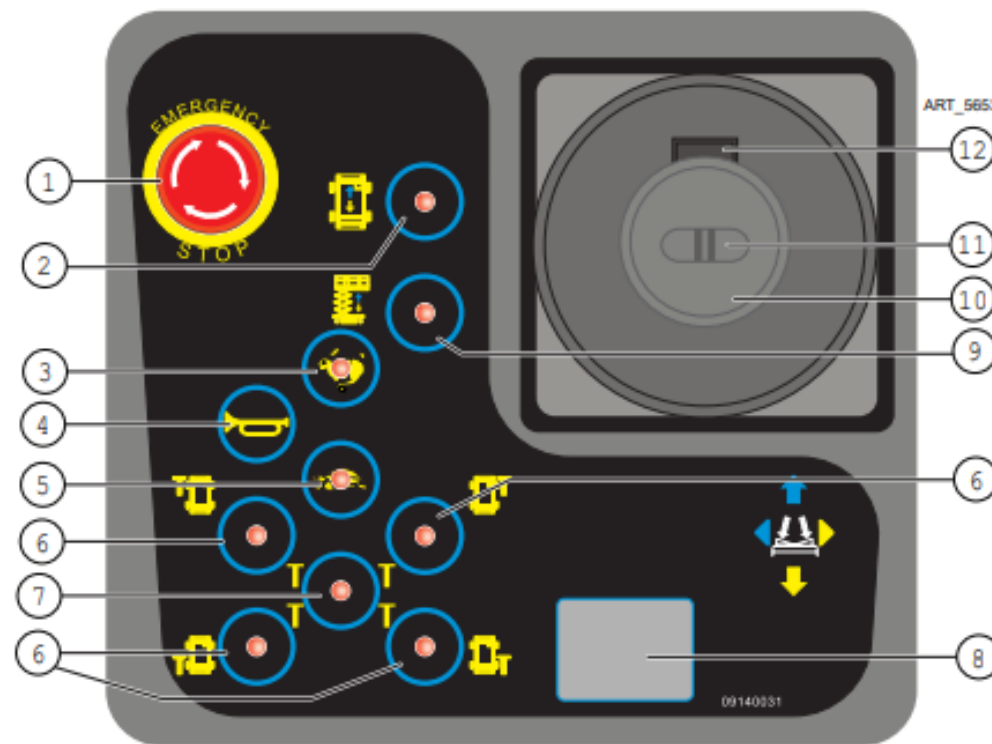

**PUSH & HOLD
OUTRIGGER
AUTO LEVEL
BUTTON**

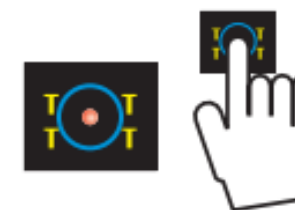

**PULL & HOLD
FUNCTION
ENABLE
SWITCH**

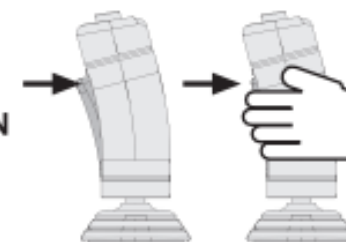

RETRACT

DEPLOY

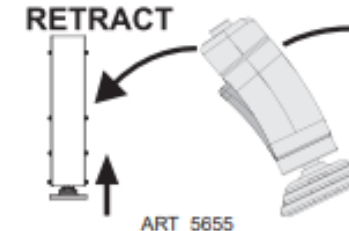

Control	Description
1 Red Emergency Stop Button	Push in the red Emergency Stop button to the off position to stop all functions. Pull out the red Emergency Stop button to the on position to operate the machine.
2 Drive Function Select Button	Press this button to activate the drive function. The indicator light will turn on.
3 High Speed Select Button	Fastest speed suitable only when on a smooth flat improved surfaces when conditions are safe.
4 Horn Button	Press this button and the horn will sound. Release the button and the horn will stop.
5 Torque Speed Select Button	High torque drive which initiates traction control valves and should be used when driving on any slopes greater than 10% or over a rough surface.

ERT Upper Controls

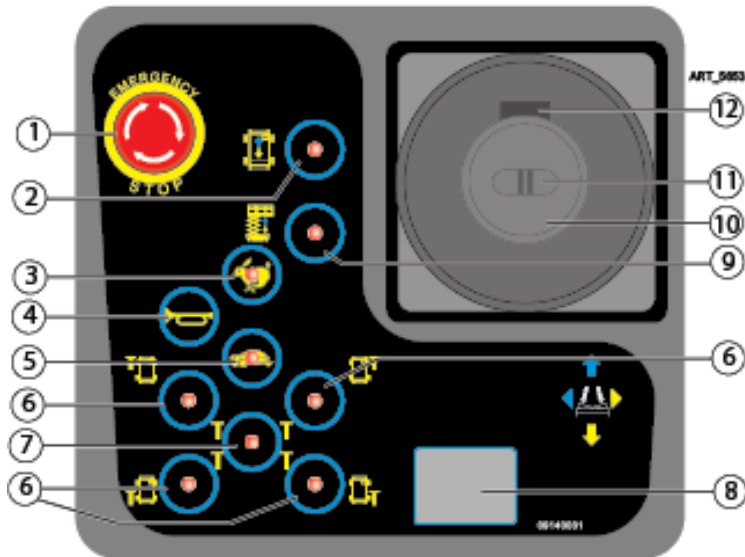

Control	Description
6	Outrigger Function Button Press this button to activate the represented individual outrigger up/down function.
7	Outrigger Auto Level Button Press this button to activate the auto level function.
8	LED Readout Screen Diagnostic readout.
9	Lift Function Select Button Press this button to activate the lift function. The indicator light will turn on.
10	Proportional Control Handle You must first select either Lift or Drive or Outrigger to activate selected function: Lift function: Press and hold the function enable switch to enable the lift function on the platform control handle. Pull the control handle in the direction of upwards and the platform will raise. Move the control handle in the direction for downwards and the platform will lower. The descent alarm should sound while the platform is lowering. Drive function: Press and hold the function enable switch to enable the drive function on the platform control handle. Move the control handle in the direction indicated by the blue arrow on the control panel and the machine will move in the direction the blue arrow points. Move the control handle in the direction indicated by the yellow arrow on the control panel and the machine will move in the direction that the yellow arrow points. Outrigger extendable / retractable function: Press and hold the function enable switch to enable the Outrigger extend/retract function on the platform control handle. Pull the control handle backward in the direction indicated by the yellow arrow and the outrigger will extend. Move the control handle in the direction indicated by the blue arrow and the outrigger will retract.
11	Thumb Rocker Switch Press the thumb rocker switch in a direction to activate steer function according to the blue and yellow steer arrows.
12	Function Enable Switch Press and hold the function enable switch to enable the drive/lift function.

Additional Emergency Controls, Features & Limitations

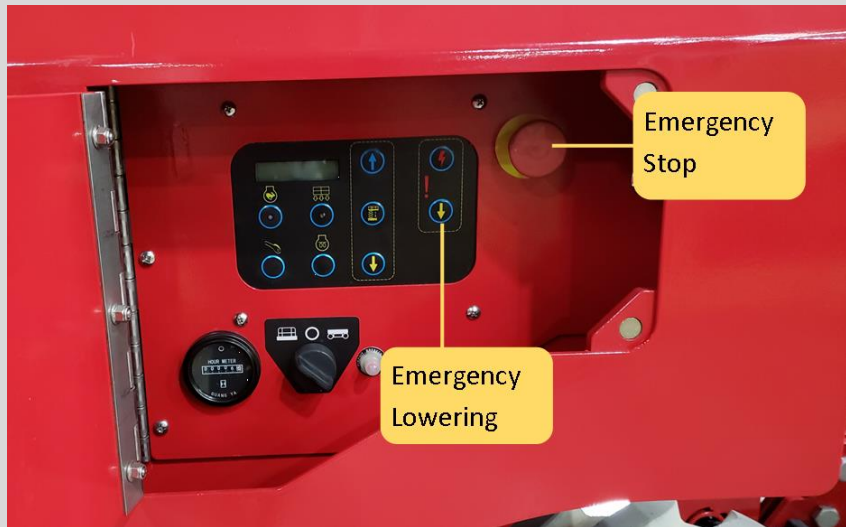

Feature	3369	4069
Max. Platform Height	33 ft.	40 ft.
Max. Platform Capacity	1,000 lbs.	800 lbs.
Max. Person(s)- Indoors	4	3
Max. Person(s)- Outdoors	2	2
Roll-Out Deck Capacity	300 lbs.	300 lbs.
Gradeability	40%	40%
Drive Speed (Stowed)	3.75 mph	3.75 mph
Raise/Lower Speed	40/40 sec	45/46 sec

- **ELECTROCUTION HAZARD! THIS MACHINE IS NOT INSULATED!**
- See operator's manual for additional information and instructions for safe use.

Operating Characteristics

Features:

- Fold-Down Guardrails
- Lanyard Attachments
- Fully Proportional Drive & Lift Controls
- Standard Integrated Sheet Material Rack
- Roll-Out Deck Extension with Incremental Lock Positions

Options:

- Auto-Leveling Outriggers
- Air Line to Platform
- Cold Start Package
- Pipe Rack

*See operator's manual for specific options and feature characteristics.

For More Information

Contact your local Dealer, Rental Provider or MEC Aerial Work Platforms.

MEC Aerial Work Platforms

- +1 (877) 632-5438
- +1 (559) 842-1500
- info@MECawp.com

MEC Parts

- +1 (559) 842-1523
- parts@MECawp.com

MEC Product Support

- +1 (559) 842-1537
- service@MECawp.com

MEC Address & Website

- 1401 S Madera Ave,
Kerman, Ca 93630
- www.MECawp.com

This information is provided as product familiarization as called for by ANSI A92.22. and CSA B 354. It is not intended to take the place of information provided by the MEC Operators manual or instruction provided by your equipment supplier. Further, all operators are to be trained before operating this equipment. Please contact MEC Aerial Work Platforms if you require additional information.