

MEWP Familiarization: 84 Series RT Speed Level®

2684RT
3084RT

84 Series RT (Speed Level®) Familiarization

(ANSI A92.22 6.2.5)

- 6.2.5.1 Prior to user's authorization of an operator to use a specific model of MEWP, the user must ensure the operator is familiarized on the following, and as specified by the manufacturer.
- Do not operate your MEWP until you have read and understood the Manufacturer's Operator Manual, have performed the workplace risk inspection, pre-start inspection, routine maintenance, and have completed all the test operations detailed in the operating instructions section of your manual.
- **Manual location is in manual enclosure on the inside of the front guardrail.**
- **Confirm that the required manual(s) as specified by the manufacturer are with the MEC 84 Series RT Speed Level®.**

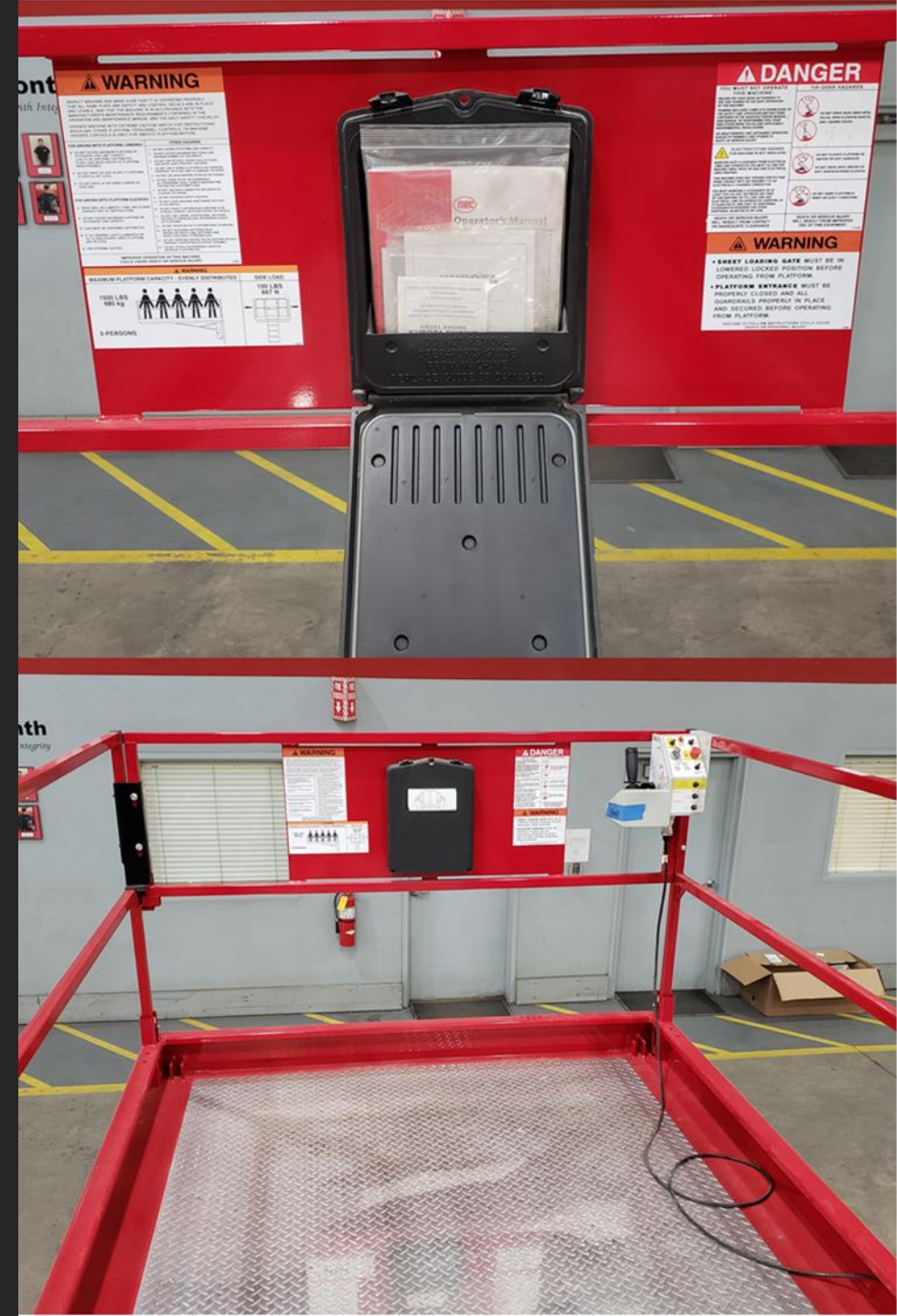

Lower Controls

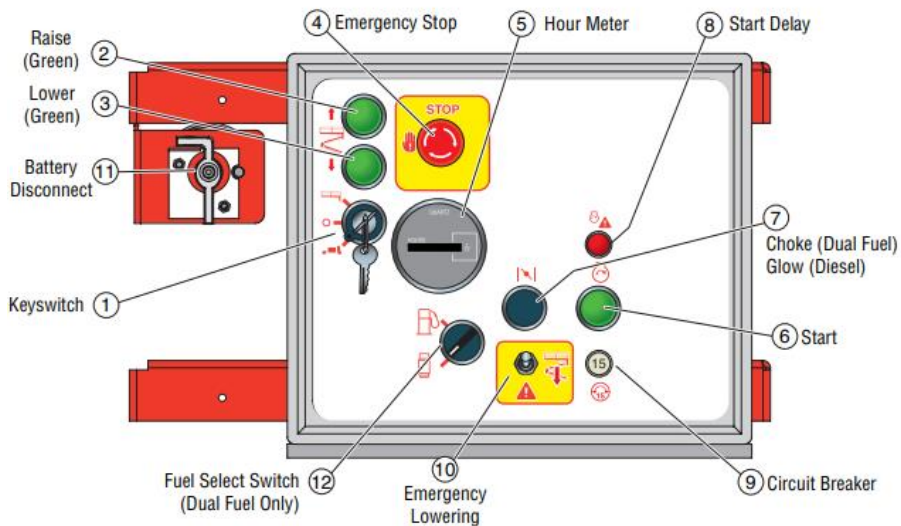

Control	Description
1 Selector Switch	PLATFORM Select to operate from the platform control panel.
	BASE Select to operate from the base control panel.
	OFF Select to stop operation from either control panel.
2 RAISE Button	Press and hold to elevate the platform. Release to stop lowering.
3 LOWER Button	Press and hold to lower the platform. Release to stop lowering.
4 EMERGENCY STOP Switch	Press to stop all machine functions. Turn Clockwise to reset.
5 Hour Meter	Indicates total elapsed time of machine operation.
6 Start Button	Press to start engine. Release when engine starts.
7 Choke/Glow	Operate when starting in cold start conditions.
8 Start Delay Light	Prevents over-cranking of engine. When lit, start is disabled. After approximately 35 Seconds the light will go out and starter can be re-engaged.
9 Circuit Breaker	Trips when there is excessive electrical load. Push to reset.
10 EMERGENCY LOWERING Switch	Push and hold the toggle switch Down to fully lower the platform.
11 Battery Disconnect	Battery power supply. Turn OFF and padlock to secure machine from unauthorized use.
12 Fuel Selector (Dual Fuel Only)	Turn switch to select Gasoline or Propane.

Upper Controls



*Some Models feature a different Control Handle

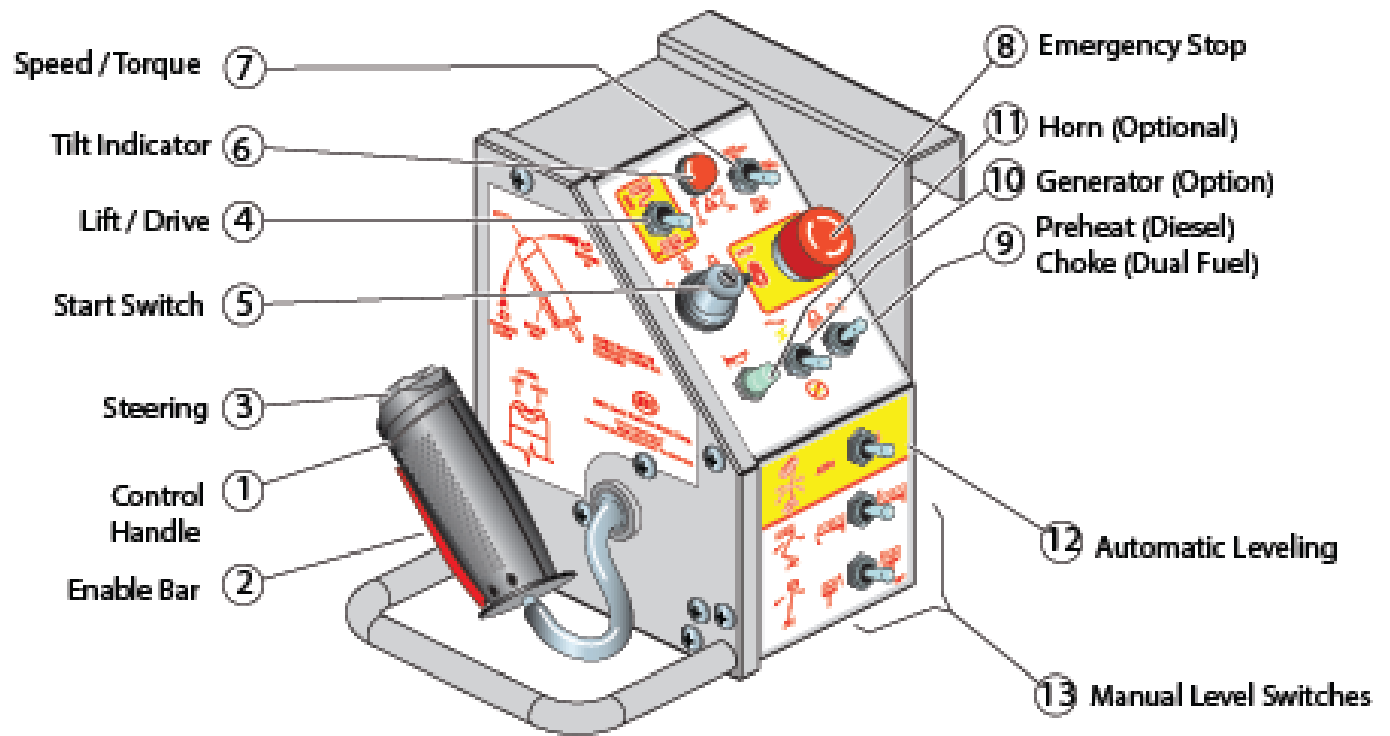

Control	Description
1	<p>DRIVE Controls Forward and Reverse travel at stepped speeds.</p> <p>LIFT Move toward operator to elevate platform. Lift speed increases proportional to the Control Handle movement. Move away from operator to lower platform. Speed is fixed.</p>
2	Squeeze to enable DRIVE, STEER, and LIFT from Control Handle.
3	Using thumb, press and hold the rocker switch to steer Left and Right.
4	Select LIFT or DRIVE function for Control Handle.
5	Turn to start engine. Switch will return to RUN position for normal operation. Turn to OFF to shut engine down.

Upper Controls

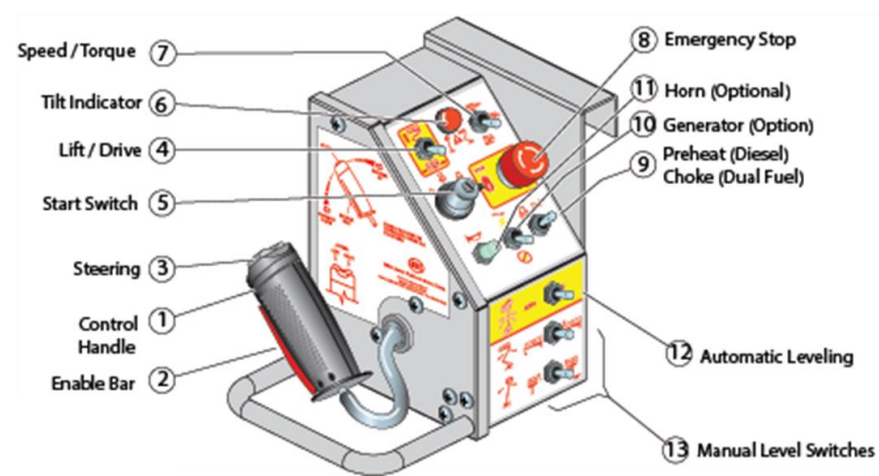

Control	Description
6 Tilt Indicator Light	Light ON indicates platform out level. Platform will not elevate when TITL light is ON.
7 Speed / Torque Switch	High Torque Slow speed. Provides maximum torque for rough terrain.
	Mid Range Mid speed. Provides medium torque for smooth to moderate terrain.
	High Speed Provides high speed when platform height is below 10 feet (3 m).
8 EMERGENCY STOP Switch	PUSH to stop all machine functions. TURN CLOCKWISE to reset.
9 Choke/Preheat	Operate when starting in cold start conditions.
10 Generator (Option)	Starts and stops optional generator.
11 Horn (Option)	Press to sound warning horn.
12 Automatic Level Switch	Move switch DOWN and hold until automatic leveling is complete.
13 Manual Level Switches	Move the upper switch to left to LOWER the front of the platform. Move the upper switch to the right to RAISE the front of the platform.
	Move the lower switch to the left to move the platform to the LEFT. Move the lower switch to the right to move the platform to the RIGHT.

Additional Emergency Controls, Features & Limitations



Feature	2684RT	3084RT
Max. Platform Height	26 ft.	30 ft.
Max. Platform Capacity	1,700 lbs.	1,500 lbs.
Deck Extension Capacity	500 lbs.	-
Ground Clearance	10 in.	10 in.
Drive Speed (Stowed)	4 mph	4 mph
Raise/Lower Speed	25/35 sec.	30/40 sec.

- **ELECTROCUTION HAZARD! THIS MACHINE IS NOT INSULATED!**
- See operator's manual for additional information and instructions for safe use.

Operating Characteristics

Features:

- Kubota Diesel Engine – Tier 4 Final Compliant
- Platform Leveling on Slopes, Automatic or Manual Selection
- 48” Roll out deck extension (2684RT only)
- Non-Skid Metal Deck Construction
- Fold-Down Guardrails
- Lanyard Attachments (6)

Options:

- Kubota Dual Fuel Engine
- Generator
- Air Line to Platform
- Removable Upper Controls
- AC Inverter

*See operator’s manual for specific options and feature characteristics.

For More Information

Contact your local Dealer, Rental Provider or MEC Aerial Work Platforms.

MEC Aerial Work Platforms

- +1 (877) 632-5438
- +1 (559) 842-1500
- info@MECawp.com

MEC Parts

- +1 (559) 842-1523
- parts@MECawp.com

MEC Product Support

- +1 (559) 842-1537
- service@MECawp.com

MEC Address & Website

- 1401 S Madera Ave,
Kerman, Ca 93630
- www.MECawp.com

This information is provided as product familiarization as called for by ANSI A92.22. and CSA B 354. It is not intended to take the place of information provided by the MEC Operators manual or instruction provided by your equipment supplier. Further, all operators are to be trained before operating this equipment. Please contact MEC Aerial Work Platforms if you require additional information.